

OLYMPIA FIELDS PARK DISTRICT

SPRING & SUMMER
2025

OF
PD



EVENTS BROCHURE

SUMMER CAMP

Register for All 9 Sessions, Get 1 Free!
Discount expires after May 20.
Registration must be paid in full.



- Session 1** June 9 – June 13
- Session 2** June 16 – June 20 (no camp June 19 – federal holiday)
- Session 3** June 23 – June 27
- Session 4** June 30 – July 4 (no camp on July 4)
- Session 5** July 7 – July 11
- Session 6** July 14 – July 18
- Session 7** July 21 – July 25
- Session 8** July 28 – August 1
- Session 9** August 4 – August 8

Youth Camp

The days of our Youth Campers are filled with sports, arts and crafts, and lots of time outside being active and exploring nature in our parks. This high energy age group will have plenty to keep them busy throughout the fun summer days. Our Youth Campers will also go on a field trip every week with the Pee Wee Camp, and spend one day every week having a splash day either Tolentine Park, or Sergeant Means Park.

Leadership Camp

Older youth can relive their summer camp days while expanding their leadership skills. Junior High and High School aged youth will play and have fun with kids their age, with the added opportunity of leadership roles. They will have opportunities to assist the counselors in planning activities for the younger kids, as well as participating in activities appropriate for their age group. They will be going on most of the same field trips as the other camps, but will occasionally take a separate field trip specifically geared towards building leadership skills. They will participate in all splash days as the Youth Camp.

Monday - Friday,
9:00 am - 4:00 pm
Sgt. Means Park, Pavilion
\$145 Non-Resident Rate (per week)
\$125 Resident Rate (per week)

Pee Wee Camp

Children in our Pee Wee Summer Camp will grow and develop while playing games, working on arts and crafts, and having fun outside. Children will play sports adapted specifically to their age and ability, and spend lots of time on the playground and exploring nature in our parks. We will also incorporate STEM in our program. Our Pee Wee's will also go on a field trip with the Youth Camp every week, and spend one day every week having a splash day either at Tolentine Park, or at Sgt. Means Park.

PEE WEE CAMP

Entering Grades: K, 1st, 2nd, 3rd

YOUTH CAMP

Entering Grades: 4th, 5th, 6th

LEADERSHIP CAMP

Entering Grades: 7th, 8th, 9th, 10th

SUMMER CAMP STARTS JUNE 9TH!



Monday - Friday

9:00 am - 4:00 pm

Sgt. Means Park, Pavilion

\$145 Non-Resident Rate (per week)

\$125 Resident Rate (per week)

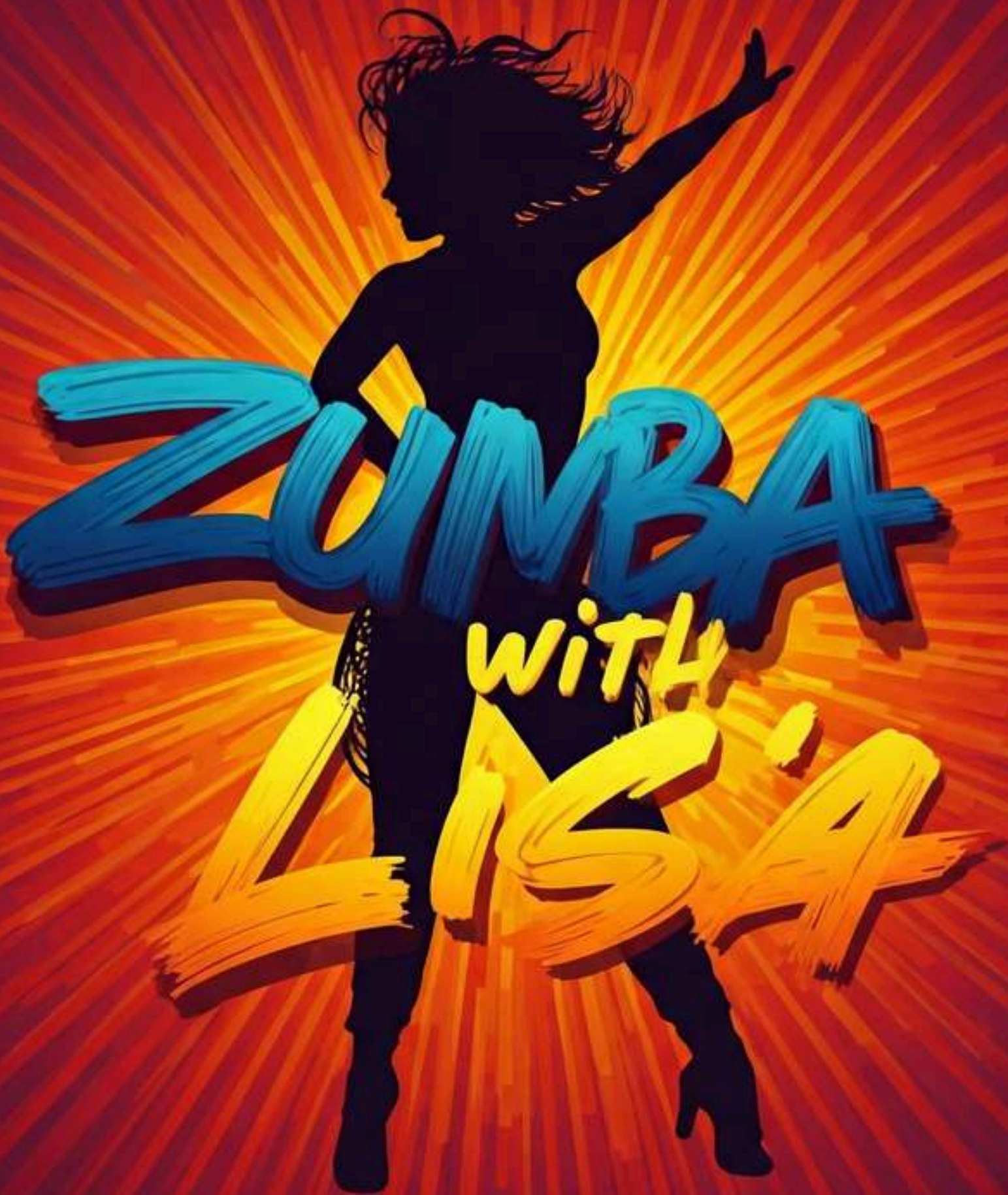

ZUMBA WITH LISA

4

ZUMBA – SATURDAY WITH LISA

As we age, exercise continues to be of critical importance to weight management, heart health, balance, and injury prevention. ZUMBA R falls under the category of endurance training, which keeps the heart healthy and the circulatory system strong. ZUMBA R develops coordination and burns calories to starve off the weight gain that often accompanies aging.

THE BRADFORD BARN MAIN BARN ROOM

\$47 Non-Resident Rate

\$38 Discounted Resident Rate

Ages 13 and older

INSTRUCTOR: LISA MCNEIL

MINIMUM 6 PARTICIPANTS

9:00 AM – 10:00 AM

CODE: 146206-01

MARCH 8 - APRIL 12

CODE: 146206-02

MAY 3 – JUNE 14*

CODE: 146206-03

JULY 12 –AUGUST 16

CODE: 146206-04

SEPTEMBER 10 - OCTOBER 25

*(No class May 31, June 7 class in Rec Room)





JUST JAMMIN' WITH JANELLE AND COMPANY

Join Janelle to learn the newest line dances and visit some of those oldies that you thought were forgotten. This is a great opportunity to have fun, boost your metabolism, and dance with your friends! See you there!

The Bradford Barn Main Barn Room (Adults Only)

\$54 Non-Resident Rate

\$43 Discounted Resident Rate

Instructor: Janelle McGhee

Minimum 8 participants

Saturdays 10:00 am – 11:00 am

Code: 142206	March 8- May 6*	(Off March 29, April 5)	(April 19 & 26 in Rec Room)
Code: 142206	May 10 – June 21*	(Off May 31)	(June 7 in Rec Room)
Code: 142206	June 28 – August 2		

TAI CHI & QIGONG

Our wonderful treasure, Master Teacher, Anpu Mfundishi, with over 47 years of practice and experience is certified by the Martial Arts Research Society and teaches both Qigong and Tai Chi classes.

Five Organ Chi Kung (Qigong) is set of basic postures and principles for quality meridian stimulation. It is a foundation for a 72 posture Tai Chi Chuan form. Working this Chi Kung set in addition of post and moving postures will provide and generate an increase in intrinsic energy and circulatory development. You will become stronger and improve memory.

The Bradford Barn Main Barn Room (Adults Only)

Mondays 6:00 pm – 7:00 pm

Thursdays 9:00 am – 10:00 am

\$67 six-week class

Instructor: Master Teacher, Anpu Mfundishi

Minimum 6 participants

MONDAYS

Code: 156005-01

January 13 – February 17

Code: 156005-02

February 24 – March 31

Code: 156005-03

April 7 – May 12

Code: 156005-04

May 19 – June 30 (no class May 26)

Code: 156005-05

July 7 – August 11

THURSDAYS

Code: 156004-01

January 16 – February 20

Code: 156004-02

February 27 – April 3

Code: 156004-03

April 10 – May 15

Code: 156004-04

May 22 – June 26 (no class June 19)

Code: 156004-05

July 10 – August 14



COMMUNITY GARDEN

Yum! Grow your own vegetables this summer! Rent a bare plot for just \$30 per plot. Plant, harvest and serve the freshest produce to your family this summer. For rules and information, stop by or contact us at 708-481-7313 ext. 221

Garden plots are available to rent!

April 1 – October 31, 2023

(weather permitting)

\$30 per plot (resident & non-resident)

Code: 810009-03

***No refund for canceled plots during current season**



**COMMUNITY
GARDEN**



WATERCOLORS PAINTING

Whether you are a beginner or have already dabbled in this medium, come and celebrate watercolor. You will explore such techniques as wet in wet, dry brush, mixed media, sepia, and color theory. Paint subjects range from nature themes, portraits, landscapes, and still life interiors. A supply list will be furnished at registration.

Adults

The Bradford Barn Main Barn Room

\$68 Non-resident Rate

\$50 Discounted Resident Rate

Instructor: Christina Denton

Minimum 6 participants

9:00 am – 11:15 am



Code: 241202-04

February 4 – March 11

Code: 241202-05

March 18 – April 29* (*no class election day April 1)

Code: 241202-06

May 5 – June 10

Code: 241202-07

June 17 – July 22

MAH JONGG FOR FUN!

**THURSDAYS
MAH JONGG
12PM-3:45PM
FREE**

**Please register at least 3
days before class**

KNITTING WORKSHOP

Tuesdays

February 11, 18, 25

2:30-4:00pm



Discover the art of knitting in this comprehensive, hands-on workshop designed for absolute beginners and those looking to refresh their skills. Learn to create beautiful, functional pieces while mastering essential techniques and building confidence.

CROCHET WORKSHOP

Thursdays

February 13, 20, 27

5:00-6:30pm



Unlock the art of crochet in our comprehensive beginner's workshop designed to transform novices into skilled crafters. Perfect for those eager to explore a new creative outlet or start a fulfilling hobby.

**\$65 PER
PERSON EACH
3-WEEK
SESSION.**

Olympia Fields
Park District

KNITTING
WORKSHOP



Kids Art in the Park

Thursdays June 5 - July 24th (no classes June 19, July 3)

4:30pm - 6:00pm

Ages 8-15

\$45 each artist

Instructor: Christina Denton

Each week we will explore Sgt. Means Park and create nature-inspired artwork through drawing and painting. All artists at all skill levels are welcome to join! All supplies included.



MOTHER'S DAY TEA & FLOWERS

Saturday, May 10

12:00-2:00 pm

\$25 per person

Enjoy tea and refreshments while crafting a beautiful tissue-paper flower bouquet for Mom or Grandma. All supplies included.



MOM

I love you so much!



FATHER'S DAY SNACKS & CRAFTS

Saturday, June 14

10:00am-12:00pm

\$25 per person

Create a personalized gift for your Father/Grandfather and enjoy refreshments. All supplies included.



DAD
forever our
knight in
shining armor

COMMUNITY GARAGE SALE IN THE PARK

All Ages (children must be accompanied by an adult)

Sgt. Means Park, Barn or Pavilion

Saturday, September 13, 2025

9:00 am – 1:00 pm

\$14 Non-Resident Rate

\$10 Discounted Resident Rate

\$30 Business Vendors

Code: 200001-03



COMMUNITY SHRED & ELECTRONIC RECYCLING DAY



**All Ages (children must be accompanied by adult)
Sgt. Means Park Parking Lot
Saturday, September 20
9:00 am – 12:00 pm**

**Free from Cook County Sheriff. They will come
and collect and shred off site**

POTTERY PAINT PARTY

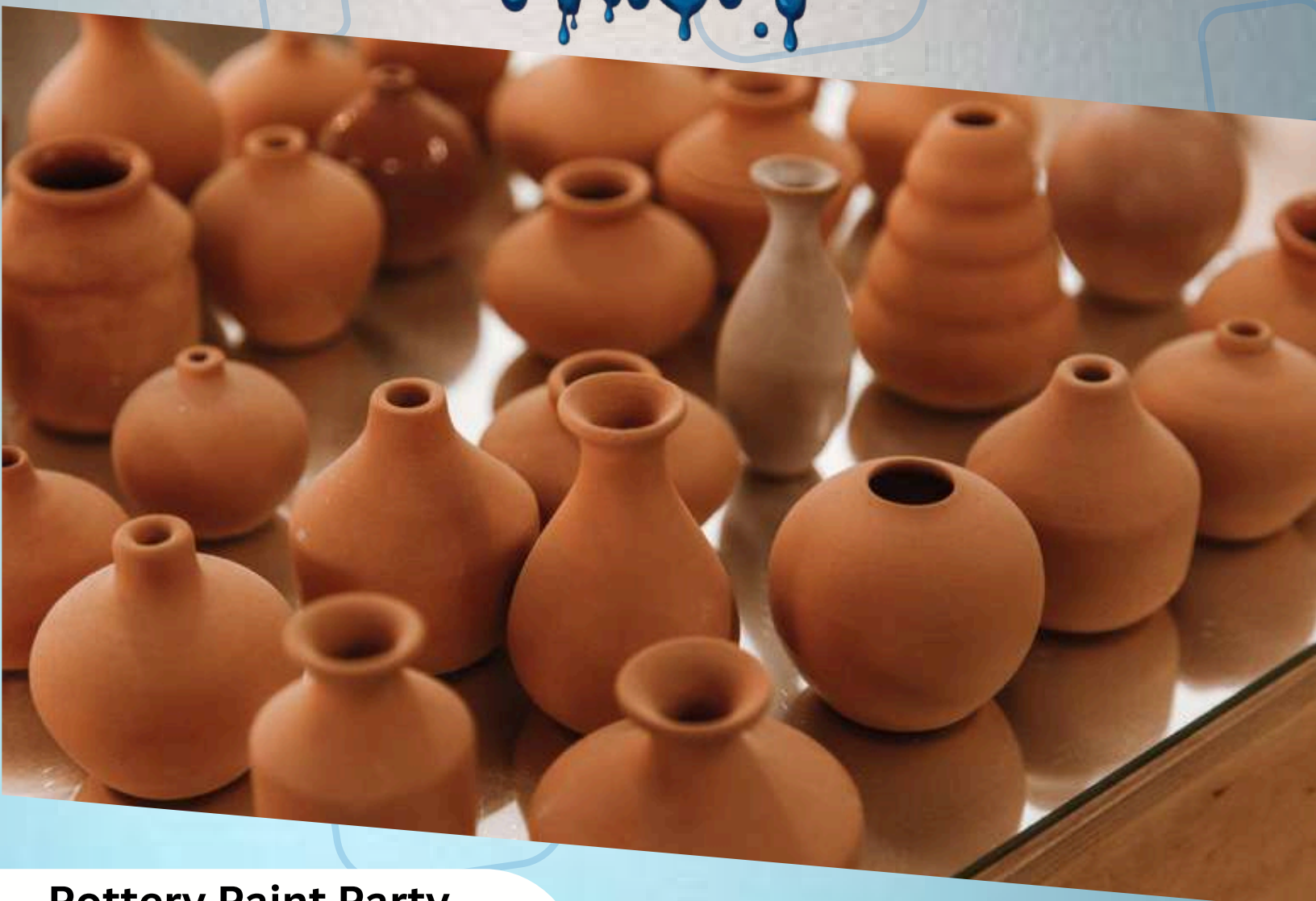

Pottery Paint Party

Sunday, April 13

2:00-4:00pm

\$35 each painter

All supplies will be provided. Pick a festive ceramic piece to paint with create a stunning ceramic masterpiece! All pieces will be supplied and 'fired' by Art4Soul in Homewood, ensuring that each piece is glossy and food safe.

EASTER BUNNY DRIVE THRU



Olympia Fields
Park District

Thursday, April 17
9am – 1pm
\$10 per stop

Easter Bunny and helpers will stop at the end of your driveway and exit our vehicle for a brief hello. This is to offered participants in the vicinity of Olympia Fields.

Let us know your time preference, your address, email, phone and the name(s) of the people we are visiting.

Email jennifer@ofparks.org or
call 708-481-7313 ext. 225 to RSVP

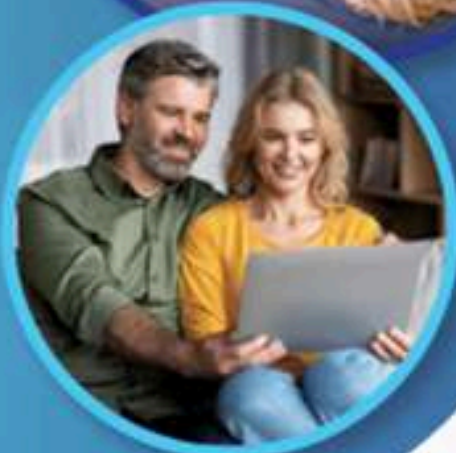

You're invited to a Life Line Screening event!

Where: Olympia Fields Park District
Bradford Barn, 20712 Western Avenue

When: Wednesday, March 12th

Life Line Screening is the nation's leader in **Stroke and Cardiovascular Disease Risk** Screenings.

Trusted by over 10 million customers.

Screenings are simple and painless. Get peace of mind or early detection.

Who should attend:

Anyone over the **age of 40**

Special Member Pricing for \$159

- ♥ Carotid Artery Disease Screening
- ♥ Atrial Fibrillation Screening
- ♥ Abdominal Aortic Aneurysm Screening
- ♥ Peripheral Artery Disease Screening
- ♥ Plus a **FREE** Hypertension Screening

4 ways to book your appointment...

Call 888-814-0466 and use
promo code HSCA001

Visit  [LLSA.SOCIAL/HSCA](https://llsa.social/hscatext)



Text the word "circle"
to 216-279-1607

These tests cannot detect all risk factors for all conditions, such as and including the presence of coronary artery disease. Those with abnormal results should discuss possible next steps with their family healthcare provider and ensure they understand the risk and benefits of any additional testing or procedures.

SENIOR VAN TRIPS



Engaging group trips designed for active seniors 60+ to explore local attractions, enjoy social interactions, and create memorable experiences together!

Gino's Steakhouse Merrillville, IN Thursday, February 20

10:30am – 3:00pm
\$25 per person (transportation)

Gino's Steakhouse in Merrillville is a well-established restaurant known for its steaks and seafood. It's a popular choice for special occasions. Highlights include their signature peppers, prime rib, and filet mignon!



Papeduex Seafood Kitchen Westmont, IL Monday, March 3

11am-3:30pm
\$27 per person (transportation only)

Papaduex Seafood Kitchen remains a highly regarded restaurant, known for its seafood offerings, vibrant atmosphere, and generally good service. It's particularly popular for special occasions and those looking for a higher-end dining experience.



SENIOR VAN TRIPS

Old Town Pour House Oakbrook, IL Friday, March 14

10:30am – 3pm
\$27 per person (transportation only)

Old Town Pour House is a trendy bar located in Oakbrook Center that offers an upscale pub dining experience with a massive beer selection showcasing local breweries. The restaurant provides a versatile atmosphere



Harvest 365 Buffet Forest Park, IL Thursday, April 10

11:00 am-3:00pm
\$30 per person
(transportation only & parking fee only)

The restaurant specializes in an all-you-can-eat buffet featuring international fare, providing diners with a diverse selection of dishes. Its location in Forest Park Plaza makes it convenient for local residents and visitors seeking a flexible dining option.



Morris, IL Thursday, April 24 10am – 5pm

\$27 per person (transportation only)

Experience small town shopping. Have fun browsing the unique stores. Enjoy homemade delicious treats. Some of the attractions: Letty Mae's Tea Room, Montage Wine Bar & Tasting Room, GypsySoul, Ricks Body & Soul Health Food Store, and many more.



SENIOR VAN TRIPS

Aurora Outdoor Outlet Mall Aurora, IL Wednesday, May 14

9:00am – 3:00pm
\$27 per person (transportation)

A Chicago Premium Outlet with 170 Name Brand Stores. Shop then have a snack or lunch. Great eats with corn dogs to handcrafted pizzas. A lot to explore including artwork. Wonderful spring day to enjoy shopping with friends.



Lincoln Park Zoo Chicago Wednesday, May 28

9:00 am-3:00pm
\$30 per person (transportation only & parking fee only)

Visitors can choose between bringing their own lunch or enjoying meals at on-site restaurants, ensuring flexibility and convenience throughout their zoo experience. With beautiful walking paths, extensive animal displays, and ample opportunities to rest and observe wildlife, this day trip promises a memorable and enriching outing for seniors seeking a delightful outdoor adventure. The zoo's accessible design and varied attractions make it an ideal destination for those looking to enjoy nature, learn about animals, and spend a pleasant day surrounded by the wonders of the animal kingdom.



SEADOG Chicago Thursday, Aug. 14

10:30am – 3:00pm
\$60 Transportation, parking & 30-minute cruise
Minimum 11 people

Enjoy Chicago's iconic skyline with an exciting speedboat Tour on Lake Michigan. Departing from Navy Pier, the Lakefront Speedboat Tour is the best way to view Chicago from the water. Seadog offers fun for the whole family (and the dog, too!) combining an exciting speedboat ride along the shoreline with informative and amusing descriptions of the world-famous Chicago skyline!



SENIOR VAN TRIPS

Greek Town Chicago, IL Monday, August 25

10:30am – 3:00pm
\$30 per person (transportation and parking)

Greektown in Chicago is a vibrant neighborhood located in the Near West Side, renowned for its rich Greek heritage, authentic cuisine, and lively cultural atmosphere. The area features numerous traditional Greek restaurants, bakeries, and specialty shops that offer visitors an immersive experience in Greek culinary and cultural traditions.



County Line Orchard Apple Picking Hobart, IN Wednesday, September 10

10:30 am-3:30pm
\$30 per person (transportation only & parking fee only)

Pick your own apples \$2 a pound

County Line Orchard in Hobart, Indiana, is a charming family-friendly destination that offers a quintessential farm experience with a variety of seasonal activities. This quaint orchard provides visitors with opportunities to enjoy apple picking, explore delightful baked goods, and participate in engaging children's activities like tractor rides and a corn maze



Boston Fish Market DesPlaines, IL Monday, September 22

10am – 5pm
\$27 per person (transportation only)

Boston Fish Market in Des Plaines is a premier seafood destination that offers an exceptional dining experience for seafood enthusiasts. The establishment stands out for its commitment to fresh seafood, offering both market and restaurant services. Diners can enjoy outdoor seating and appreciate the family-friendly atmosphere,





Annual Blood Drive
Saturday, April 26
Bradford Barn
10:00am – 2:15pm

ANNUAL
BLOODDRIVE

OLYMPIA FIELDS PARK DISTRICT PRESENTS

Cape Cod, Martha's Vineyard, & Plymouth



INCREDIBLE PRICE INCLUDES:

- ◆ Motorcoach transportation
- ◆ 6 nights lodging including 4 consecutive nights in the quaint Cape Cod area
- ◆ 10 meals: 6 breakfasts and 4 dinners
- ◆ A visit to Plymouth, MA and famous "Plymouth Rock"
- ◆ An escorted visit to lovely, artistic Martha's Vineyard
- ◆ A Guided Tour of the historic seaside towns of Hyannis and Sandwich
- ◆ A visit to the JFK Museum
- ◆ A Guided Tour of the "Outer Cape", including Provincetown and Chatham

For more pictures, video, and information visit:
www.GroupTrips.com/OlympiaFieldsParkDistrict

\$1065*

7 Days 6 Nights

*PER PERSON, DOUBLE OCCUPANCY

(Sun - Sat) Sep 7 - 13 2025



Picturesque Provincetown



Lighthouse overlooking Vineyard Sound



Experience 17th century history in Plymouth, MA



One of Cape Cod's many Windmills

Departure: Olympia Fields, IL @ 8 am

Day 1: Board your spacious, video and restroom equipped Motorcoach and set off for beautiful Cape Cod! Tonight, you will check into an en route hotel for a good night's rest.

Day 2: Enjoy a Continental Breakfast at your hotel, before arriving in Cape Cod - the perfect example of all that is New England! This evening you will have Dinner and check into your Cape Cod area accommodations for a four night stay.

Day 3: Enjoy a Continental Breakfast and embark on your GUIDED TOUR OF HYANNIS and SANDWICH. Start off with a visit to the lovely Village of HYANNIS where you'll stop at the JFK MUSEUM - an exhibit designed to open a window on the days JFK spent on Cape Cod. Next, you'll visit the John F. Kennedy Memorial in HYANNIS. Lastly, you'll head to the quaint and historic village of SANDWICH. Tonight, end your day with a relaxing Dinner.

Day 4: After a Continental Breakfast, a Guide will accompany you on a ferry ride to the famous getaway island - MARTHA'S VINEYARD. Upon arrival, enjoy free time to soak up the charm of this lovely island with its unique shops, quaint restaurants, and historical sites. Later this afternoon, you'll depart Martha's Vineyard and enjoy Dinner at a local restaurant.

Day 5: After a Continental Breakfast you will depart for a GUIDED TOUR OF THE OUTER CAPE. See the Eastham Windmill, the Cape Cod National Seashore, Race Point Visitor Center, and the Marconi Station area with its spectacular "ocean to bay" view across the entire cape. Then, you'll make a stop in colorful PROVINCETOWN - home to artists, great galleries, stores and boutiques. Next, you'll breathe in the sea air in CHATHAM with its panoramic views of the Atlantic and rustic barrier beaches. Tonight, enjoy Dinner and entertainment.

Day 6: Enjoy a Continental Breakfast before departing for a visit to Plymouth, MA - "America's Hometown!" See the famous "Plymouth Rock." This evening relax at your en route hotel.

Day 7: Today, after enjoying a Continental Breakfast, you will depart for home... a perfect time to chat with your friends about all the fun things you've done, the great sights you've seen, and where your next group trip will take you!

ADD SOME PEACE OF MIND TO YOUR TRIP...
 With Diamond Tours Exclusive Travel ConfidentSM Protection Plan.
 See separate advertisement...

\$75 Due Upon Signing. *Price per person, based on double occupancy. Add \$229 for single occupancy.
 Final Payment Due: 6/30/2025

FOR INFORMATION & RESERVATIONS CONTACT:

Jennifer Braun-Denton @ (708) 481-7313 Ext. 221

OLYMPIA FIELDS PARK DISTRICT PRESENTS

New Hampshire & the White Mountains



INCREDIBLE PRICE INCLUDES:

- ◆ Motorcoach transportation
- ◆ 8 nights lodging including 4 consecutive nights in New Hampshire
- ◆ 15 meals: 8 breakfasts, 1 lunch, and 6 dinners
- ◆ Experience a 1.3 Mile Scenic Gondola Ride to the Summit of Loon Peak
- ◆ Enjoy a 2.5 Mile Train Ride at Clark's Trading Post
- ◆ Admission to the Wright World War II Museum including 14,000 artifacts and Military Vehicles
- ◆ See a Live Bear Show & the Chinese Acrobats Show
- ◆ Enjoy a Scenic Narrated Cruise on Lake Sunapee
- ◆ Enjoy a Narrated Trolley Tour of Wolfeboro
- ◆ Exclusive Diamond Tours Dinner Party with Entertainment

For more pictures, video, and information visit:
www.GroupTrips.com/OlympiaFieldsParkDistrict

\$1535*

9 Days 8 Nights

*PER PERSON, DOUBLE OCCUPANCY

(Sat - Sun)
 Jun 21 - 29
 2025

Departure: Olympia Fields, IL @ 8 am

Day 1: Board your spacious, video and restroom equipped Motorcoach and set off for New Hampshire. Tonight, check into an en route hotel for a good night's rest.

Day 2: After enjoying a Continental Breakfast, you will depart for the Arboretum at Penn State in University Park, PA. Later in the day, enjoy Dinner and check into your en route hotel.

Day 3: Today after enjoying Continental Breakfast, you'll arrive in picturesque New Hampshire. Tonight, you'll enjoy Dinner before checking into your hotel for a four night stay.

Day 4: Start with a Continental Breakfast, then you'll head to beautiful Lake Sunapee for a narrated SCENIC LAKE CRUISE departing from Sunapee Harbor. Come aboard, and take-in the beautiful scenery. This afternoon, you will enjoy a memorable group photo opportunity located at an overlook on the Kancamagus Highway. This evening, enjoy an exclusive Diamond Tours Dinner Party with Entertainment!

Day 5: Begin the day by enjoying a Continental Breakfast, before departing for the WRIGHT WORLD WAR II MUSEUM. This award-winning museum has over 14,000 items in collections representing both the home front and the battlefield and a vast collection of fully operational military vehicles. Next, you'll enjoy a NARRATED TROLLEY TOUR of WOLFEBORO. Discover Wolfeboro's unique colonial heritage, scenic views of Lake Winnepesaukee, beautiful waterfront homes, and many other points of interest. Tonight, enjoy Dinner at a local restaurant before returning to your hotel.

Day 6: After a Continental Breakfast, you'll depart for CLARK'S TRADING POST. Upon reaching your destination, you will have the opportunity to watch A LIVE BEAR SHOW. Let bears Darla and Hildie entertain you with their tricks as they follow in the "paw prints" of their famous bear predecessors. You'll also see the CHINESE ACROBATS SHOW. Take a break and enjoy a light Lunch including a fresh deli sandwich. This lunch is included with your tour. Then, enjoy a famous 2.5 mile Train Ride. Travel across the Pemigewasset River through a 1904 covered bridge. Continue on your journey to Loon Mountain. Enjoy a 1.3-mile SCENIC GONDOLA RIDE to New Hampshire's summit of Loon Peak. Upon reaching the summit, you'll be greeted with fresh mountain air and breathtaking views. Later tonight, enjoy Dinner at a local restaurant.

Day 7: Enjoy a Continental Breakfast before leaving for the Faneuil Hall Marketplace in Boston, MA. Later that day, after a relaxing Dinner, you'll check into your en route hotel.

Day 8: Today you will have Continental Breakfast and then go to Steamtown - a National Historic Site in Scranton, PA. Tonight, relax in your en route hotel.

Day 9: Today after enjoying a Continental Breakfast, you depart for home... a perfect time to chat with your friends about all the fun things you've done, the great sights you've seen and where your next group trip will take you!



See a Live Bear Show



Experience a 1.3 Mile Scenic Gondola Ride



Enjoy a Fun Train Ride



Scenic Narrated Cruise on Lake Sunapee

ADD SOME PEACE OF MIND TO YOUR TRIP...
 With Diamond Tours Exclusive Travel Confident[®] Protection Plan.
 See separate advertisement...

\$75 Due Upon Signing. *Price per person, based on double occupancy. Add \$549 for single occupancy.
 Final Payment Due: 4/14/2025

FOR INFORMATION & RESERVATIONS CONTACT:

Jennifer Braun-Denton @ (708) 481-7313 Ext. 221

OLYMPIA FIELDS PARK DISTRICT PRESENTS

Washington, DC - Our Nation's Capital



INCREDIBLE PRICE INCLUDES:

- ◆ Motorcoach transportation
- ◆ 6 nights lodging including 4 consecutive nights in the Washington, DC area
- ◆ 10 meals: 6 breakfasts and 4 dinners
- ◆ Guided Tour of Washington, DC including the WW II Memorial, Capitol Hill, Embassy Row, the Korean War Veterans Memorial, the Vietnam Veterans Memorial, the Martin Luther King, Jr. National Memorial, the Lincoln Memorial, and more!
- ◆ Evening Guided Memorial and Monuments Tour
- ◆ Full Day visit to the Smithsonian National Museum of African American History & Culture
- ◆ Full Day admission to the Museum of the Bible

For more pictures, video, and information visit:
www.GroupTrips.com/OlympiaFieldsParkDistrict

\$995*

7 Days 6 Nights

*PER PERSON, DOUBLE OCCUPANCY

(Thu - Wed)
Mar 20 - 26
2025

Departure: Olympia Fields, IL @ 8 am

Day 1: Depart your group's location in a spacious, video and restroom equipped Motorcoach and set off for our Nation's Capital - Washington D.C. Tonight, check into an en route hotel for a good night's rest.

Day 2: Today, after enjoying a Continental Breakfast you will continue towards Washington, D.C. Upon arrival, enjoy a relaxing Dinner and check into your Washington D.C. area hotel for a four night stay.

Day 3: Enjoy a Continental Breakfast before departing for a full-day Guided Tour of Washington, D.C. Some of the awe-inspiring sights on this fantastic tour will include the US Capitol, the White House, the National Archives, Embassy Row, and Georgetown. During the day, you will see the Washington Monument, Lincoln Memorial, the Martin Luther King, Jr. National Memorial, and several War Memorials. This evening, enjoy Dinner at a local restaurant before continuing on the Guided Memorial and Monuments Tour.

Day 4: Begin the day with a Continental Breakfast. Today, you will enjoy a full day visit to the Smithsonian National Museum of African American History & Culture. Later, you'll enjoy Dinner with entertainment before returning to your hotel for the night.

Day 5: Enjoy a Continental Breakfast before departing for a full day visit to the Museum of the Bible. Discover the history, narrative and impact the Bible has played in our world's history. From the 40 foot tall bronze doors at the museum's entrance, to the roof-top garden, explore over six floors of exhibits that span the time, space and cultures of the Bible. With over 40,000 items, the Museum of the Bible's collection contains some of the oldest and most important biblical artifacts and documents in human history. This evening, enjoy a relaxing Dinner and return to your hotel.

Day 6: Enjoy a Continental Breakfast before leaving for the National Harbor, a unique waterfront wonderland of shopping, dining, and more. This evening, relax at your en route hotel.

Day 7: Today, after enjoying a Continental Breakfast, you will depart for home... a perfect time to chat with your friends about all the fun things you've done, the great sights you've seen, and where your next group trip will take you!

ADD SOME PEACE OF MIND TO YOUR TRIP...
With Diamond Tours Exclusive *Travel Confident*® Protection Plan.
See separate advertisement...

\$75 Due Upon Signing. *Price per person, based on double occupancy. Add \$305 for single occupancy.
Final Payment Due: 1/13/2025



Capitol Building



World War II Memorial



Martin Luther King, Jr.
National Memorial



Washington Monument

FOR INFORMATION & RESERVATIONS CONTACT:

Jennifer Braun-Denton @ (708) 481-7313 Ext. 221



Help Put Your Mind at Ease on the Next Trip...

with the **Travel Confident® Protection Plan!**

Travel Protection - Same Price - Regardless of Age!

**ADD SOME PEACE OF MIND TO YOUR TRIP...
with the Travel Confident® Protection Plan.**

Easy online sign-up is available at: www.travelconfident.com

Travel Confident® Protection Plan can no longer be purchased by check or money order.

**See separate advertisement flyer from your group leader for
additional details and an important disclaimer.**

**Travel Protection is available as part of Diamond Tours®, Inc.
Exclusive Travel Confident® Protection Plan.**



Olympia Fields
Park District

OLYMPIA FIELDS PARK DISTRICT

ADOPT A PARK SIGN GARDEN PROGRAM

The Olympia Fields Park District's Adopt a Park Sign Garden Program is a volunteer program designed for citizens who wish to take an active role in the beautification of the Park District gardens around park signs. Groups or individuals are encouraged to take an active role in their neighborhood and community parks planting and maintaining flower gardens that surround the park signs. If you are interested in volunteering, contact Jesus Vargas 708-481-7313 x 226

Parks where volunteers are currently needed for 2024:

- Bicentennial Park
- The Trails Parks
- Arcadia Park
- Elliott Woods Park
- Spirit Trail Park

OLYMPIA FIELDS PARK DISTRICT

TREE & BENCH COMMEMORATIVE PROGRAM

Celebrate a special occasion, honor someone you hold dear or remember a loved one by donating a tree or bench. A tree or bench makes a lovely gift or memorial and also contributes to the beauty and variety of the park landscape.

A tree spreads its strength and beauty across the years to become a lasting recognition of remembrance. Trees will be planted either in the spring or fall of each year as weather permits, depending on the species of tree. Application deadline is March 1st for spring and September 1st for fall.

Benches require an 8-10 week lead time from the date of the initial order to final installation.

Ordering Information:

To order a tree or bench, please call the Olympia Fields Park District Maintenance Department at 708-481-7313, Jesus Vargas - ext. 226. We will assist you with the process of selecting a tree or bench, deciding on the wording for the plaque, and choosing a fitting location for your memorial.

"A man doesn't plant a tree for himself. He plants it for posterity."

...Alexander Smith

PARK RENTALS

PICNIC RENTALS

Picnic Rentals Picnic Area Rentals can be contracted and approved up to one year in advance!

BICENTENNIAL PARK

- Located at 203rd & Governor's Highway
- 1 Covered Picnic Area
- 3 Soccer Fields
- 2 Baseball Fields

PICNIC EQUIPMENT RENTAL

Picnic Kit - \$25 Rental Fee

Our Picnic Kit includes: 4 throw down bases, 2 Frisbees, 2 softball bats, 2-12" softballs, 2-16" softballs, 1 hard bat, 1 hard ball, 1 Wiffle ball bat, 1 Wiffle ball, 1 soccer ball, 1 playground ball, 1 volleyball, and 1 basketball.

In addition to the Picnic Kit, we have the following separate items available to rent for \$5 each:

- Frisbee
- Horseshoes
- Bocce Balls
- Baggo (Bean Bag Toss game)



PARK RENTALS

PARK RENTALS

LEAGUE RENTALS

Looking for a home for your Softball, Soccer, Football, Tennis or Frisbee Golf League?

We have just the place for you! Athletic field rentals at Sgt. Means Park and Bicentennial Park.

\$35 per Game / Non-resident

\$25 per Game / Discounted resident rate

Security deposit \$100

HOME OWNER ASSOCIATION

Olympia Fields Park District Home Owner Associations Rent Bicentennial or Sgt. Means Park Picnic Areas free for your yearly picnics. Deposits and other applicable rules and fees may apply.



PARK RENTALS

PARK RENTALS

RENTAL FEES AND SECURITY DEPOSIT INFORMATION

The following rates apply regardless of weather conditions. No refunds will be given based on weather conditions. Max of 8 Hour Picnic Park Rentals.

BICENTENNIAL PARK

# of Guests	Resident	Non-Resident
1-10	\$30*	\$60*
11-60	\$85*	\$170*
61-100 max	\$110*	\$220*

***Requires a \$100 security deposit**

Alcoholic Permit and Liability Fees \$225 - Non-refundable

Refunds available within 30 days of event. Checks to be picked up in office.

All cancellations must be in writing to the park district 60 days prior to the rental date. Otherwise, the security deposit will be forfeited. In case of cancellation, a processing charge of 50% of deposit will be retained if more than 60 days from rental date. Less than 60 days you will forfeit deposits.

Teen parties or large groups require additional security fees. All outdoor rentals that will have 100 or more attendees must be approved by the park board.

No park water usage. No water slides.
Inflatables must be approved. Must rent own generator.

No amplified music (including DJs) allowed in any park.

Additional rental fees may apply depending on type of entertainment and/or rental equipment. Other rules and regulations apply. Please contact our office for further details.

Rentals less than 60 days away must be paid in full. Payments accepted for rentals less than 60 days from event must be made by credit card, money order or cash. Call office for further details.

PARK RENTALS

TOLENTINE PARK RENTALS

PICNIC RENTAL

Picnic area and tables until dusk
 1 - 60 Guests
 \$220 Non-Resident Rate
 \$110 Discounted Resident Rate
 \$100 Security Deposit



FOR SCHOOLS, CAMPS, AND DAYCARES ONLY

Splash Pad can accommodate Schools, Camps, and Daycares at a discounted rate:
 \$150 for 90 minutes
 \$50 security deposit (same rules apply)

*Schools camps and daycares can only rent from 10:00am-11:30am Monday - Friday

MAX 8 REGULAR PARK PICNIC RENTALS.

Alcoholic Permit and Liability Fees \$225 - Non-refundable

No barbecuing at this park location. No Inflatables

Rentals less than 60 days away must be paid in full at the time of booking. Payments accepted for rentals must be made by credit card, money order, or cash. Call office for further details.

All cancellations must be in writing to the park district 60 days prior to the rental date. Otherwise, the security deposit will be forfeited. In case of cancellation, a processing charge of 50% will be retained if more than 60 days from rental date.

Refunds for security deposit available within 30 days after event. Splash Pad admission fee is not included. Regular splash pad admission fee will apply.

All park rental rules and regulations apply. Additional rules and regulations may apply for Tolentine Park rentals. Please contact Olympia Fields Park District for details.

Rentals must be booked at least 2 weeks in advance. Call 708-481-7313 to reserve the Splash Pad!

PARK RENTALS

FRISBEE DISC GOLF

Welcome to the Olympia Fields Park District's 18-hole disc golf course, a thrilling blend of precision and nature. Our course, nestled in the scenic Olympia Fields landscape, caters to players of all skill levels.

Experience the joy of disc golf as you navigate through a well-designed course that seamlessly integrates with the natural surroundings. Tall trees, manicured fairways, and strategic obstacles provide the right balance of challenge and enjoyment. Designed for both beginners and seasoned disc golfers, each hole offers a unique set of challenges, from narrow fairways to open spaces, along with elevation changes for added excitement.

Take in the tranquility of the park as you progress through the course, with convenient benches and rest areas for a leisurely pace. Well-maintained baskets and clearly marked tee pads ensure a smooth and enjoyable round. Whether you're aiming for a birdie or conquering a tricky par, our 18 holes promise an unforgettable disc golf experience.

Discover the joy of disc golf at the Olympia Fields Park District's 18-hole course! A perfect opportunity to connect with nature, challenge yourself, and create lasting memories with friends and family.



**WE SELL DISC
GOLF FRISBEES
IN THE OFFICE!**



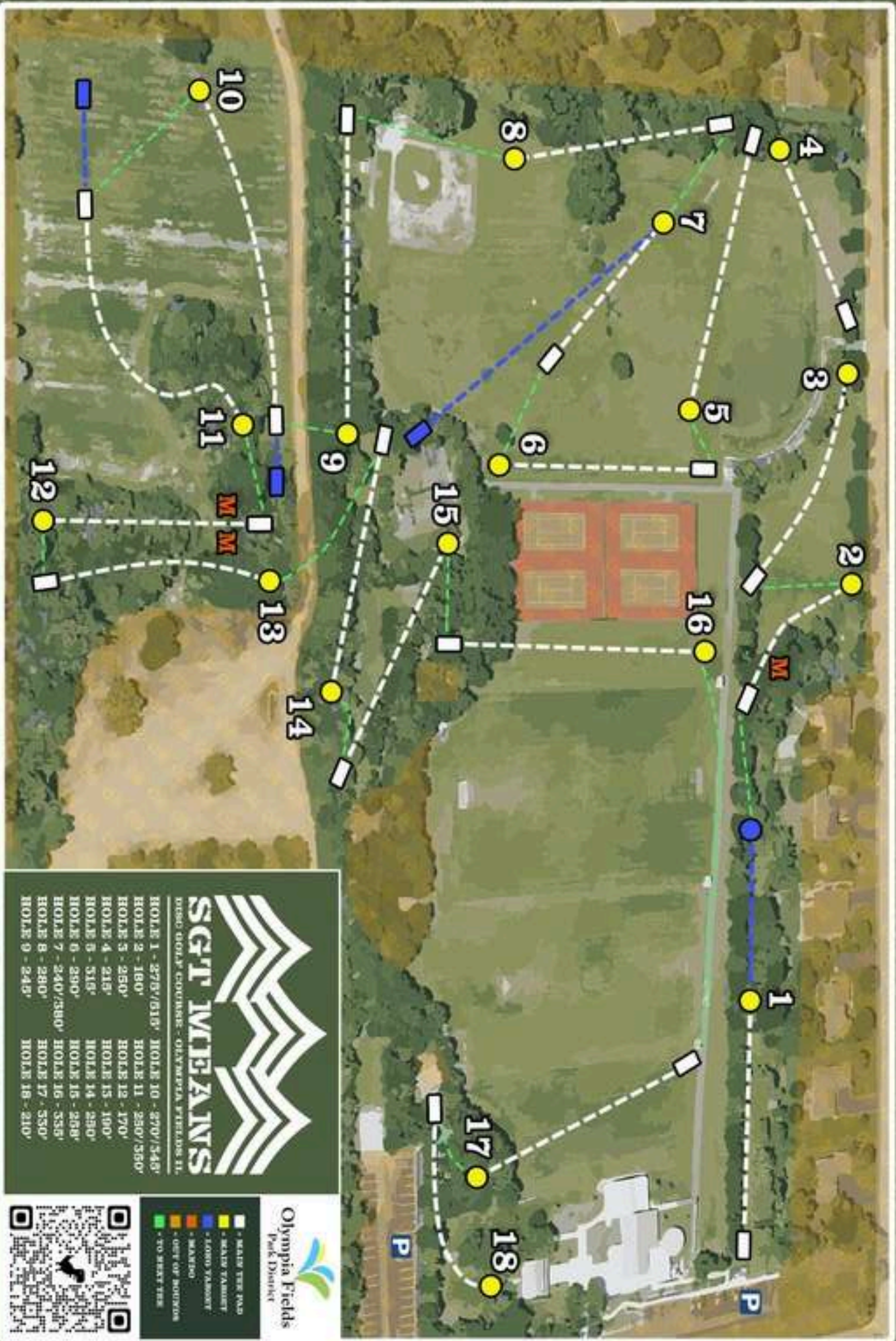

SGT MEZANS

DESIGNER: GOLF COURSE - OLYMPIA FIELDS II

HOLE 1 - 375'/515'	HOLE 10 - 270'/345'
HOLE 2 - 180'	HOLE 11 - 250'/350'
HOLE 3 - 250'	HOLE 12 - 170'
HOLE 4 - 215'	HOLE 13 - 190'
HOLE 5 - 315'	HOLE 14 - 280'
HOLE 6 - 390'	HOLE 15 - 258'
HOLE 7 - 240'/380'	HOLE 16 - 335'
HOLE 8 - 280'	HOLE 17 - 330'
HOLE 9 - 245'	HOLE 18 - 210'

Olympia Fields
Park District

- MAIN TEE PAD
- MAIN TARGET
- LONG TARGET
- MARKER
- GOLF SHOP BUILDING
- TO REEF TEE



the bradford barn

Whether you are planning a wedding, bridal shower, party, celebration, corporate retreat, workshop, retirement dinner, or an association meeting, our facilities can provide the perfect setting for you.

CULL HOUSE LIVING ROOM

Ideal for groups of up to 18 people.

SMALL RECREATION ROOM

Presentations for 8 to 24 people.

THE SILO

Ideal for groups of up to 40 people.

MAIN BARN ROOM

Ideal for groups of up to 128 people.

PAVILION

Ideal for groups of up to 150 people.

* Excludes Pavilion rental special 150 with bundle pricing only

TOURS, PRICING, AND RENTAL PACKAGES

Feel free to stop by at any time for a tour of the venue during office hours, you do not need to make any appointment!

Please contact Christina Denton at 708-481-7313 or christina@ofparks.org to schedule an appointment or for information about pricing and rental packages.



The Bradford Barn rental bundle includes:

- Venue set up
- Main Barn Room
- Pavilion (Open air) (Seasonal: May-Oct)
- Silo
- Catering Kitchen
- Loft for DJ
- Facility Attendant
- High boy tables (6) if desired
- White chairs, round tables, rectangle tables
- Access to audio equipment

4 hours minimum
12 hours maximum
(All Events must end by 12 A.M including decoration and cleanup)

We offer special wedding reception packages that include use of Main Barn Room (Ideal for groups of up to 120 people), Outdoor Pavilion (Ideal for groups of up to 140 people during May - October), Silo Room, Catering Kitchen, Cull House living room (Bridal Suite).

Seasonal Bundle Rates
(May -October)

Non-Resident Rates	Resident Rates
4 Hours: \$1560	4 Hours: \$1326
6 Hours: \$2340	6 Hours: \$1989
8 Hours: \$3120	8 Hours: \$2652
10 Hours: \$3900	10 Hours: \$3491
12 Hours: \$4680	12 Hours: \$3987

- \$500 Security Deposit in addition to bundle rates
- \$300 per hour outside of bundle hours listed.
- \$35 per hour OFPD Security Fee required for groups 99+ and teen parties 50+
- \$225 Alcohol Liability Insurance available.



Recreation Room
Individual Room Rate

Recreation Room can be used for:

- Seats 24
- Possible Groomsman Room
- Possible Coat room
- \$80 - Per Hour, Non-Resident Rate
- \$50 - Per Hour, Resident Rate
- \$100 additional security deposit



Cull House
Individual Room rate

Cull House can be used for:

- Bridal Suite Photos
- Seats 14
- \$45 - Per Hour Non-Resident
- \$30 - Per Hour Resident Rate
- \$100 additional security deposit

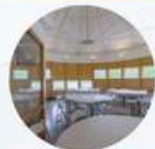

Silo Room
Individual Room Rate

Silo Room can be used for:

- Additional seating, buffet, photos.
- Wedding cake, dessert spread, baby shower, bridal shower
- Seats 40
- \$75 - Per Hour, Non-Resident Rate
- \$55 - Per Hour, Resident Rate
- \$100 additional security deposit



Main Barn Room
Individual Room Rate

Main Barn can be used for:

- Seating capacity 125
- Seats 90 with room for dance floor
- \$225 - Per Hour, Non-Resident
- \$191.25 - Per Hour, Resident Rate
- \$300 additional security deposit



Pavilion
Individual Room Rate

Pavilion can be used for:

- Dance floor, Wedding ceremony or general events.
- \$225 - Per Hour Non-Resident Rate
- \$191.25 - Per Hour Resident Rate
- \$300 additional security deposit



Catering Kitchen
Individual Room Rate

Catering Kitchen can be used for:

- Freezer
- Refrigerator
- Food warmer
- Microwave
- Ice Maker
- Kitchen is added to all indoor rentals FREE

THE BRADFORD BARN



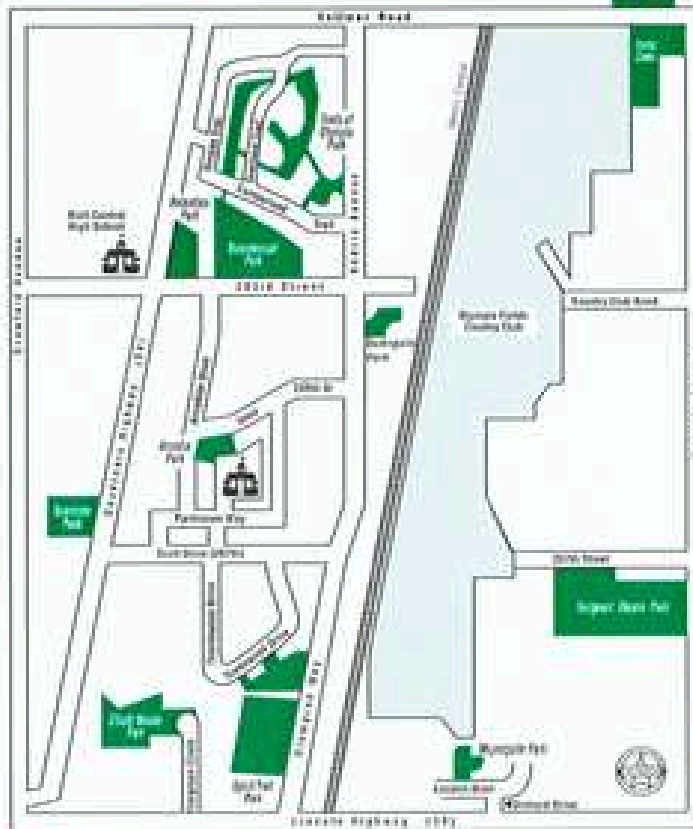

■ Parks, Trails and District Parks

	Acres	Playground Apparatus	Athletic Fields	Picnic Areas	Seeding Hill	Tennis Courts	Basketball Court	Nature Area	Sitting Area	Bicycle Path	Disc Golf	Community Gardens	Meeting Facilities	Picnic Shelter	Concession Stand	Restrooms	Splash Pad
Arcadia Park Arcadian Drive	1.5	X	X	X	X				X								
Biocentennial Park 203rd and Governor's Hwy	14	X	X	X	X				X	X				X	X	X	
DeAngelis Park Kedzie Ave. & Metro Station	3.1								X	X							
Elliott Woods Park Evergreen Circle	6.8							X									
Irons Oaks Environmental Learning Center Western and Vollmer	40			X				X	X				X	X		X	
Maynegate Park Orchard and London Drive	4.2	X	X	X					X								
Sgt. Means Park 207th and Western Avenue	20	X	X	X	X	X	X	X	X	X	X		X	X		X	
Spirit Trail Park Kedzie Avenue	35.5							X									
Tolentine Park 207th and Governor's Hwy	10	X	X	X			X	X	X	X		X		X			X
Trails of Olympia North of Biocentennial Park	12.4								X	X							
Total Acres	144.7																

1. Proof of residency (utility or tax bill) will be checked by the Park District staff upon registration.
2. Park District residents receive a discounted rate, as they pay taxes to the district. (*Graymoor residents are not considered residents. Their tax dollars go to a different district*)
3. Any applicant or participant may be required at any time to provide reasonable proof of age, residency, marital status or dependency.
4. You must complete the registration form and submit with full payment when registering for a program.
5. Registration is accepted at the Park District office (The Barn) located at: 20712 Western Avenue Olympia Fields, IL 60461
6. Online registration is available on the district website: www.ofparks.org.
7. Pre-registration is necessary for most Park District programs.
8. All registration is done on a first come, first served basis. No space will be reserved until the appropriate program fee is paid.
9. Payment is accepted in the form of: cash, check, money order or credit card (Visa or MasterCard). Please make checks payable to: Olympia Fields Park District.
10. A \$35 fee will be charged for any returned check. Only cash will be taken in place of the NSF check.

11. Program Fees will not be prorated when registering for a program if the class session has already started or you cannot attend the class dates as listed.
12. Waiting lists will be formed when a class is full. Every attempt will be made to open an additional class.
13. Programs may be cancelled prior to the start date due to low enrollment. Refunds will be issued in the form of a check or return of charges to credit card used in the transaction within 30 days of request. A refund in the form of a check will be available for pick up within 30 days. All programs or rental refunds to be received in the form of a check will be written to the person whose name appears on the original registration/rental. Checks will be available by pick-up only, no checks will be sent through the mail. A \$20 administrative fee will be added to any refund deposit check not cashed within the 90-day timeframe and need to be reprinted.

Refund Policies

1. In the event a program, trip, or event is cancelled by the Park District, each registrant will be notified and a full refund will be issued and available for pick up within 30 days.
2. A \$5 administration fee will be assessed on all refund requests by the participant. Refund requests for all programs (excluding trips) must be requested prior to the second class meeting. Refunds will not be approved past the start of the second class meeting. Refunds will be ready for pick up within 30 days of request.
3. No refunds will be given for trips past the registration deadline date- unless there is a waiting list and someone can take the place from that waiting list.



BOARD OF COMMISSIONERS

- Deborah Robinson, President
- Trinette Britt-Johnson, Commissioner
- Lori Carlton-Jordan, Commissioner
- Steven Hurley, Commissioner
- Neil Pierce, Commissioner
- Eric Anderson, Attorney

ADMINISTRATIVE STAFF

- Jesus Vargas, Executive Director
- Jennifer Braun-Denton, Facilities Supervisor & Adult programs
- Christina Denton, Facilities Recreation Supervisor
- Beverly Meekins, Treasurer

BEHAVIOR POLICY

The Park District reserves the right to dismiss a participant from a program if their behavior or language is deemed inappropriate by staff, or if it prevents fellow participants from having the best experience possible.

LOOKING TO VOLUNTEER?

Several of our Park District programs have been successful due to the individuals who volunteer their time to assist us in the programs we offer. The Park District is looking for individuals to assist with programs and special events. If you would like to get involved, please stop by the Park District office and fill out a volunteer application. Please note for which programs/events you would like to volunteer.

ADA CONFORMITY

Olympia Fields Park District intends to comply with the intent and spirit of the Americans with Disabilities Act (ADA). If you require special accommodations, call the Park District at 708-481-7313 so that we can make necessary accommodations.

PARK DISTRICT OFFICE LOCATION

Sgt. Means Park, The Bradford Barn
20712 Western Avenue Olympia Fields,
Illinois 60461
708-481-7313 (phone)
708-481-8735 (fax)
www.ofparks.org

OFFICE HOURS

Monday - Friday: 9:00 am - 4:00 pm
Saturday: 9:00 am - Noon
Sunday: Closed

BOARD MEETING DATES

The Olympia Fields Park District Board of Park Commissioners meets the third Tuesday of each month at 6:00 pm.

EMERGENCY CLOSING INFORMATION

www.EmergencyClosings.com
(847) 238-1234

PHOTOGRAPHY POLICY

Olympia Fields Park District uses photographs in programs and special events to inform others of the many recreational opportunities available in our community. We do not use identification in our brochure. If you do not wish to have your picture taken, please inform the photographer. The Park District does not control newspaper photographers or others who may photograph program participants.

LOCAL ORGANIZATIONS

Enhancement Organization of Olympia Fields
Contact: Willett Hudson info@eoof.org

Park Forest Library
400 Lakewood Blvd. Park Forest, IL 60466
708-748-3731
www.pfpl.org

Olympia Fields Women's Club
Contact: Lola Prouix 708-481-8393

HF-Olympia Fields Soccer Club
708-802-4100
(general information and girls program)
708-802-2697
(boys program) www.hfsoccerclub.org

Hope springs eternal

DONATE BLOOD

The 5th Annual Kristin Arielle Oliver Memorial Blood Drive

Kristin Oliver continues to help give the gift of life after her death. A world traveler, friend & the loving light to all those she touched with her kindness. Kristin passed away after a 2 year battle fighting a rare heart cancer. Throughout her chemo treatment, regular lifesaving blood treatments were required. Please honor Kristin's legacy of hope, faith & love by donating blood in her memory.



SATURDAY
April 26
2025

SAVE THE DATE TO DONATE: Saturday, April 26, 2025

For more details or sponsorship/support, contact pam.newslady@gmail.com.

Co-Hosted by Family of Kristin Oliver, NBC-5 Chicago, Center for Food Equity in Medicine, Olympia Fields Park District, Sickle Cell Disease Association of Illinois, & Top Ladies of Distinction.

*Your non-perishable food items are also welcomed.

Helpful tip: Make sure to eat a healthy meal and drink plenty of water before donating.



Center for Food Equity in Medicine



versiti
Blood Centers

Office Closures

The office will be closed on the following dates:

- Friday, April 18, 2025 (Good Friday)
- Monday, May 26, 2025 (Memorial Day)
- Thursday, June 19, 2025 (Juneteenth)
- Friday, July 4 (Independence Day)
- Monday, September 1 (Labor Day)
- Monday, October 13 (Columbus Day)
- Tuesday, November 11 (Veterans Day)
- Thursday, November 27 – November 29 (Thanksgiving Holiday)
- Wednesday, December 24 – December 26 (Christmas Holiday)
- Wednesday, December 31 – January 2, 2026 (New Year's Holiday)
- Monday, January 19, 2026 (Martin Luther King Day)
- Monday, February 16, 2026 (Presidents Day)



Olympia Fields Park District
20712 Western Ave, Olympia Fields, IL 60461
[708] 481-7313
ofparks.org